

# Surface Mount Inductor (Coils) Tape and Reel Specifications

1. Reel Dimensions

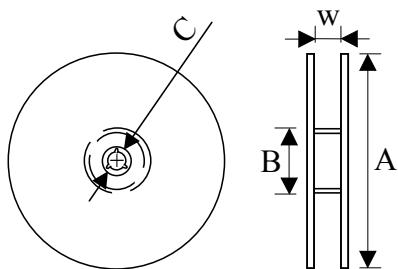

2. Tape Dimensions

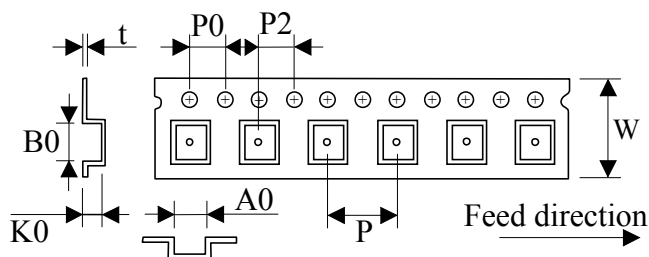

TOKEN Part No.	Piece / Reel		Reel Dimensions				Tape Dimensions							
	178	330	A	B	C	W	A0	B0	K0	P	P0	P2	W	t
<u>Chip Wirewound Inductor Molded Type (CM)</u>														
TRCM322522	2,000	-	178	60	13	9	2.80	3.50	2.30	4	4	2	8	0.30
TRCM453232	500	-	178	60	13	13	3.60	4.90	3.20	8	4	2	12	0.30
<u>Chip Wirewound Inductor Molded Type (EC)</u>														
TREC322522	2,000	-	178	50	13	10	2.88	3.65	2.50	4	4	2	8	0.26
TREC453232	500	-	178	50	13	14	3.31	4.95	3.50	8	4	2	12	0.35
<u>Chip Wirewound Inductor Molded Type (EM)</u>														
TREM322522	2,000	-	178	50	13	10	2.88	3.65	2.50	4	4	2	8	0.26
TREM453232	500	-	178	50	13	14	3.31	4.95	3.50	8	4	2	12	0.35
<u>Chip Multilayer Inductor for High Frequency (MF)</u>														
TRMF100505	10,000	-	178	60	13	9	0.65	1.12	0.60	2	4	2	8	-
TRMF160808	4,000	-	178	60	13	9	1.10	1.80	0.95	4	4	2	8	-
<u>SMD High Frequency Multilayer Inductor (MI)</u>														
TRMI160808	4,000	-	178	60	13	9	1.05	1.85	0.95	4	4	2	8	-
TRMI201209	4,000	-	178	60	13	9	1.58	2.42	0.95	4	4	2	8	-
TRMI201212	3,000	-	178	60	13	12	1.35	2.25	1.35	4	4	2	8	0.22
TRMI321611	3,000	-	178	60	13	9	1.88	3.50	1.27	4	4	2	8	0.22

Continued on the following page. 

↑ Continued from the preceding page.

TOKEN Part No.	Piece / Reel		Reel Dimensions				Tape Dimensions							
	178	330	A	B	C	W	A0	B0	K0	P	P0	P2	W	t
<u>SMD Wirewound Inductors Chip Open-Type (WL)</u>														
TRWL100505	4,000	-	178	60	13	9	0.72	1.19	0.60	4	4	2	8	-
TRWL160808	4,000	-	178	60	13	9	1.35	1.95	0.95	4	4	2	8	-
TRWL160808	4,000	-	178	60	13	9	1.12	1.85	0.96	4	4	2	8	0.23
TRWL201212	2,000	-	178	60	13	9	1.85	2.30	1.45	4	4	2	8	0.23
TRWL201212(L)	2,000	-	178	60	13	9	1.80	2.30	0.90	4	4	2	8	0.23
TRWL201212(H)	2,000	-	178	60	13	9	1.85	2.30	1.45	4	4	2	8	0.23
TRWL321611	2,000	-	178	60	13	9	1.95	3.50	1.50	4	4	2	8	0.23
TRWL252005	2,000	-	178	60	13	9	2.70	2.80	2.00	4	4	2	8	0.23
TRWL252005(L)	2,000	-	178	60	13	9	2.70	2.80	1.50	4	4	2	8	0.23
TRWL252005(H)	2,000	-	178	60	13	9	2.70	2.80	2.00	4	4	2	8	0.23
<u>Thin Film Chip Inductor (AL)</u>														
TRAL100505	10,000	-	178	60	13.5	9.5	0.70	1.16	0.40	2	4	2	8	-
TRAL160808	5,000	-	178	60	13.5	9.5	1.10	1.90	0.60	4	4	2	8	-
<u>High Current Multilayer SMD Beads Inductor (MA)</u>														
TRMA/B100505	10,000	-	178	60	13	6	0.65	1.15	0.70	2	4	2	8	-
TRMA/B160808	4,000	-	178	60	13	6	1.10	1.85	0.95	4	4	2	8	-
TRMA/B201209	4,000	-	178	60	13	6	1.58	2.42	0.95	4	4	2	8	-
TRMA/B321611	3,000	-	178	60	13	6	1.88	3.50	1.27	4	4	2	8	0.20
TRMA/B321616	2,000	-	178	60	13	6	1.88	3.64	1.90	4	4	2	8	0.20
TRMA/B322513	2,500	-	178	60	13	6	2.77	3.42	1.65	4	4	2	8	0.20
TRMA/B451616	2,000	-	178	60	13	10	1.88	4.95	1.90	4	4	2	12	0.30
TRMA/B453215	1,000	-	178	60	13	10	3.66	4.95	1.85	8	4	2	12	0.30
<u>SMD Inductor Flat Top Air Core (AM)</u>														
TRAM0603	-	4,000	330	100	13	12.5	1.55	2.00	2.00	8	4	2	12	0.30
TRAM0805	-	4,000	330	100	13	12.5	1.55	2.50	2.00	8	4	2	12	0.30
TRAM1008	-	4,000	330	100	13	12.5	1.55	3.20	2.00	8	4	2	12	0.30
TRAM2215	-	4,000	330	100	13	12.5	1.60	2.40	1.50	8	4	2	12	0.30
TRAM4015	-	4,000	330	100	13	12.5	1.60	4.20	1.50	8	4	2	12	0.30
TRAM3730	-	2,500	330	100	13	12.5	3.50	4.00	3.20	8	4	2	12	0.30
TRAM7030	-	2,000	330	100	13	16.5	3.50	7.00	3.20	8	4	2	16	0.30
TRAM1812	-	2,000	330	100	13	16.5	5.45	6.80	4.00	8	4	2	16	0.30
TRAM132	-	1,000	330	100	13	16.5	4.70	9.10	4.90	8	4	2	16	0.30
<u>RFID Transponder Coils (TR4308I)</u>														
TR4308I	-	3,000	330	100	13	24.5	3.30		2.70	8	4	2	24	0.35
<u>SMD EMI Filters Common Mode (TCPWC)</u>														
TCPWCH05	2,000	-	178	60	13	9	1.40	2.55	1.35	4	4	2	8	-
TCPWCH06	2,000	-	178	60	13	9	1.90	3.50	2.10	4	4	2	8	-

Continued on the following page. ↓

↑ Continued from the preceding page.

TOKEN Part No.	Piece / Reel		Reel Dimensions				Tape Dimensions							
	178	330	A	B	C	W	A0	B0	K0	P	P0	P2	W	t
<u>SMD Choke Coils Common Mode (TCB4F/5F/5FL)</u>														
TCB4F	-	2,000	330	100	13	12.5	4.40	5.40	3.50	8	4	2	12	0.40
TCB5F	-	1,000	330	100	13	16.5	6.40	6.90	4.60	12	4	2	16	0.40
TCB5FL	-	1,500	330	100	13	16.5	6.40	6.90	3.95	12	4	2	16	0.40
<u>Power Inductors SMT Shielded (RB)</u>														
TPSR63B	-	1,500	330	100	13.5	16	6.50	7.10	4.55	12	4	2	16	0.40
TPSR74B	-	1,000	330	100	13.5	24	7.80	8.50	5.60	12	4	2	16	0.40
TPSR105B	-	500	330	100	13.5	24	9.65	10.90	6.00	12	4	2	24	0.40
<u>Power Inductors SMT Shielded (RH)</u>														
TPSRH62B	-	1,500	330	100	13.5	16	6.70	6.70	3.50	12	4	2	16	0.40
TPSRH64B	-	1,000	330	100	13.5	16	6.70	6.70	3.80	12	4	2	16	0.40
TPSRH73	-	1,000	330	100	13.5	16	8.00	8.00	3.50	12	4	2	16	0.40
TPSRH74	-	1,000	330	100	13.5	16	8.00	8.00	4.20	12	4	2	16	0.40
TPSRH124	-	700	330	100	13.5	24	12.50	12.50	5.05	16	4	2	24	0.40
TPSRH125	-	500	330	100	13.5	24	12.50	12.50	6.10	16	4	2	24	0.40
TPSRH127	-	450	330	100	13.5	24	12.50	12.50	8.10	16	4	2	24	0.40
TPSRH124B	-	500	330	100	13	24.5	12.55	12.55	5.05	16	4	2	24	0.35
TPSRH125B	-	500	330	100	13	24.5	12.55	12.55	6.40	16	4	2	24	0.35
TPSRH127B	-	500	330	100	13	24.5	12.55	12.55	8.10	16	4	2	24	0.35
TPSRH103R	-	1,000	330	100	13.5	24	10.50	10.60	3.20	16	4	2	24	0.40
TPSRH104R	-	1,000	330	100	13.5	24	10.50	10.60	4.20	16	4	2	24	0.40
TPSRH105R	-	700	330	100	13.5	24	10.50	10.60	5.20	16	4	2	24	0.40
TPSRH2D18A	-	3,500	330	100	13.5	12	3.30	3.30	2.10	8	4	2	12	0.40
TPSRH3D16A	-	3,500	330	100	13.5	12	4.30	4.30	1.90	8	4	2	12	0.40
TPSRH3D16	-	3,500	330	100	13.5	12	4.30	4.30	1.90	8	4	2	12	0.40
TPSRH3D18	-	3,500	330	100	13.5	12	4.30	4.30	2.10	8	4	2	12	0.40
TPSRH3D28	-	3,500	330	100	13.5	12	4.30	4.30	3.10	8	4	2	12	0.40
TPSRH4D18	-	3,500	330	100	13.5	12	5.10	5.10	2.10	8	4	2	12	0.40
TPSRH4D28	-	2,000	330	100	13.5	12	5.10	5.10	3.10	8	4	2	12	0.40
TPSRH5D18	-	2,000	330	100	13.5	12	6.00	6.00	2.10	8	4	2	12	0.40
TPSRH5D28	-	2,000	330	100	13.5	12	6.00	6.00	3.10	8	4	2	12	0.40
TPSRH6D28	-	1,500	330	100	13.5	12	7.10	7.10	3.10	8	4	2	12	0.40
TPSRH6D38	-	1,000	330	100	13.5	16	7.10	7.10	4.10	12	4	2	16	0.40
TPSRH8D28	-	1,000	330	100	13.5	16	10.50	8.20	3.20	12	4	2	16	0.40
TPSRH8D43	-	500	330	100	13.5	16	10.50	8.20	5.00	12	4	2	16	0.40

Continued on the following page. ↓

↑ Continued from the preceding page.

TOKEN Part No.	Piece / Reel		Reel Dimensions				Tape Dimensions							
	178	330	A	B	C	W	A0	B0	K0	P	P0	P2	W	t
<u>Power Inductors SMT Shielded (DS)</u>														
TPSDS0620	-	2,000	330	100	13.5	12	6.20	6.20	2.10	8	4	2	12	0.30
TPSDS0625	-	2,000	330	100	13.5	12	6.30	6.30	2.60	8	4	2	12	0.30
TPSDS0630	-	2,000	330	100	13.5	16	6.20	6.20	3.10	8	4	2	12	0.40
TPSDS0635	-	1,500	330	100	13.5	16	6.35	6.35	3.55	12	4	2	12	0.40
TPSDS104	-	500	330	100	13.5	16	10.30	10.30	5.10	16	4	2	24	0.35
TPSDS106	-	500	330	100	13.5	16	10.60	10.60	7.00	16	4	2	24	0.50
TPSDS126	-	500	330	100	13.5	16	12.50	12.50	8.10	16	4	2	24	0.35
<u>Power Inductors SMT Shielded (SLF)</u>														
TPSLF6028	-	1,500	330	100	13.5	16	6.20	6.20	3.20	12	4	2	16	0.40
TPSLF7032	-	1,500	330	100	13.5	16	7.20	7.20	3.60	12	4	2	16	0.40
TPSLF7045	-	1,000	330	100	13.5	16	7.20	7.20	5.00	12	4	2	16	0.40
TPSLF10145	-	700	330	100	13.5	24	12.70	12.70	5.00	16	4	2	24	0.40
TPSLF12555	-	500	330	100	13.5	24	12.70	12.70	6.00	16	4	2	24	0.40
TPSLF12565	-	500	330	100	13.5	24	12.70	12.70	7.00	16	4	2	24	0.40
TPSLF12575	-	450	330	100	13.5	24	12.70	12.70	8.00	16	4	2	24	0.40
<u>Power Inductors SMT Shielded (DC)</u>														
TPS1608DC	-	2,500	330	100	13.5	16.5	4.25	6.50	3.00	8	4	2	16	0.35
TPS3316DC	-	1,000	330	100	13.5	24	9.70	13.40	5.20	20	4	2	24	0.40
TPS5022DC	-	250	330	100	13.5	32	15.20	18.70	7.70	20	4	2	32	0.40
<u>SMD Power Inductor Shielded (SH)</u>														
TPSH0301	-	3,500	330	100	13.5	12.0	4.30	4.30	1.40	8	4	2	12	0.30
TPSH0302	-	3,500	330	100	13.5	12.0	4.30	4.30	1.95	8	4	2	12	0.30
TPSH0303	-	2,500	330	100	13.5	12.0	4.30	4.30	3.00	8	4	2	12	0.30
TPSH0501	-	4,000	330	100	13.5	12.0	5.30	5.30	1.50	12	4	2	12	0.30
TPSH0502	-	3,500	330	100	13.5	12.0	5.30	5.30	2.05	12	4	2	12	0.30
TPSH0503	-	2,500	330	100	13.5	12.0	5.30	5.30	3.00	12	4	2	12	0.30
TPSH0601	-	1,500	330	100	13.5	16.0	6.30	6.30	1.10	12	4	2	16	0.30
TPH06015	-	1,500	330	100	13.5	16.0	6.30	6.30	1.60	12	4	2	16	0.30
TPSH0603	-	1,500	330	100	13.5	16.0	6.30	6.30	2.10	12	4	2	16	0.30
TPH06025	-	1,500	330	100	13.5	16.0	6.30	6.30	2.60	12	4	2	16	0.30
TPSH0603	-	1,500	330	100	13.5	16.0	6.30	6.30	3.10	12	4	2	16	0.30
<u>Power Inductors SMT Unshielded (UD)</u>														
TPUD4006	1,000	-	178	62	13	12.5	5.80	6.30	1.30	8	4	2	12	0.40
TPUD4008	1,000	-	178	62	13	12.5	5.80	6.30	1.30	8	4	2	12	0.40
TPUD4011	1,000	-	178	62	13	12.5	4.50	5.60	1.55	8	4	2	12	0.40
TPUD4013	1,000	-	178	62	13	12.5	4.50	5.60	1.55	8	4	2	12	0.40
TPUD5011	-	4,500	330	100	13	16.5	5.90	7.50	1.70	8	4	2	12	0.40
TPUD5013	-	4,500	330	100	13	16.5	5.90	7.50	1.70	8	4	2	12	0.40

Continued on the following page. ↓

↑ Continued from the preceding page.

TOKEN Part No.	Piece / Reel		Reel Dimensions				Tape Dimensions							
	178	330	A	B	C	W	A0	B0	K0	P	P0	P2	W	t
<u>Power Inductors SMT Unshielded (UTC)</u>														
TPU31A	-	3,500	330	100	13.5	12	3.5	4	1.7	8	4	2	12	0.40
TPU31	-	3,500	330	100	13.5	12	3.5	4	1.7	8	4	2	12	0.40
TPU32	-	3,000	330	100	13.5	12	3.5	4	2.4	8	4	2	12	0.40
TPU42	-	3,000	330	100	13.5	12	4.5	5	2.4	8	4	2	12	0.40
TPU43	-	2,000	330	100	13.5	12	4.5	5	3.8	8	4	2	12	0.40
TPU52	-	2,500	330	100	13.5	16	5.70	6.3	2.4	8	4	2	16	0.40
TPU53	-	2,000	330	100	13.5	16	5.70	6.3	3.8	8	4	2	16	0.40
TPU54	-	1,500	330	100	13.5	16	5.70	6.3	4.8	8	4	2	16	0.40
TPU73	-	1,000	330	100	13.5	24	7.70	8.4	4.3	12	4	2	24	0.40
TPU75	-	1,000	330	100	13.5	24	7.70	8.4	5.6	12	4	2	24	0.40
TPU104	-	1,000	330	100	13.5	24	9.65	10.9	4.3	12	4	2	24	0.40
TPU105	-	900	330	100	13.5	24	9.65	10.9	5.7	12	4	2	24	0.40
TPU106	-	500	330	100	13.5	24	9.65	10.9	6.5	12	4	2	24	0.40
<u>Power Inductors SMT Unshielded (ULF)</u>														
TPULF7032	-	1,500	330	100	13.5	16	7.20	7.20	3.60	12	4	2	16	0.40
TPULF7045	-	1,000	330	100	13.5	16	7.20	7.20	5.00	12	4	2	16	0.40
<u>Power Inductors SMT Unshielded (UDF)</u>														
TPU1608DF	-	2,500	330	100	13.5	16	4.25	6.50	3.00	8	4	2	16	0.40
TPU3308DF	-	1,000	330	100	13.5	24	9.70	13.40	3.10	20	4	2	24	0.40
TPU3316DF	-	1,000	330	100	13.5	24	9.70	13.40	5.20	20	4	2	24	0.40
TPU3340DF	-	250	330	100	13.5	24	9.70	13.40	11.50	20	4	2	24	0.40
TPU5022DF	-	250	330	100	13.5	32	15.20	18.70	7.70	20	4	2	32	0.40
<u>Power Inductors SMT Unshielded (UDHP)</u>														
TPU1813DHP	-	1,500	330	100	13.5	16	6.30	9.10	5.60	12	4	2	16	0.40
TPU3316DHP	-	1,000	330	100	13.5	24	10.10	13.40	6.60	20	4	2	24	0.40
TPU5022DHP	-	250	330	100	13.5	32	15.40	22.50	7.30	20	4	2	32	0.40
<u>Power Inductors SMT Backlight Shielded (DBL)</u>														
TPS1608DBL	-	2,500	330	100	13	16.5	4.25	6.50	3.00	8	4	2	16	0.35
<u>SS</u>														
TPUTX-2P/2S	-	500	330	100	13	24.5	10.25	10.25	5.50	16	4	2	24	0.40
TPUTX-4P/4S	-	500	330	100	13	24.5	12.70	12.70	7.00	16	4	2	24	0.40

*Back to 1st Page - Surface Mount Inductor (Coils) Tape and Reel Specifications*